

ISEB Intermediate Certificate in Software Testing

E-learning Course



ILX Group's ISEB Intermediate Certificate course is a fully interactive multimedia based course designed for Companies and Individuals that leads to the Information Systems Examination Board (ISEB) Intermediate Certificate in Software Testing. The certificate is the next level of competency in software testing after foundation level and covers everything required by the ISEB syllabus, with the emphasis on helping delegates to understand, remember and apply knowledge and applicable skills.

Achieving a pass in this certificate provides evidence that the candidate has proven analytical ability, having gained knowledge and practical skills in the key topics required for practising software testing.

Benefits

- An exam simulator which results in exceptional pass rates
- Increased retention of learning
- Less time taken to learn
- Increased control and visibility of progress and achievement
- Reduced travel costs
- Accessible from any location

Target Audience

The topics covered in this qualification are those which are considered by ISEB to be essential knowledge for a practising test professional, regardless of their specialism, for instance: Test Analysts, Test Team Leaders and Test Managers.

Candidates must already hold the ISEB Foundation Certificate in Software Testing.

Why e-learning?

Technological improvements and advances in educational design mean that e-learning is no longer just a low cost alternative to traditional training methods. In many respects our courseware offers training which is superior to the majority of available "classroom" options.

Not only is the effectiveness of the training process enhanced, but also the convenience and overall cost efficiency of e-learning makes it a compelling option for training. Training can be targeted at specific individual requirements and staff learn exactly what they need, any time, any place. Staff also learn at their own pace and can repeat each section as many times as they need during the course and as a refresher.

Accreditation

The examination is a multiple choice examination incorporating scenario-based questions. A key aim of the examination is to provide candidates with an opportunity to think through the implications of the context of a question, rather than simply selecting from a choice of options so practical experience can be applied. The pass mark for the Intermediate Certificate exam is 60%.

What's included?

- The full course can be delivered via CD-ROM, network, intranet or hosted by ILX
- It consists of a rich multimedia presentation including animation, sound and interactive exercises
- A full student user guide reflecting the course content
- Additional features such as sticky notes, a 'favourites' function, corporate notes, review bar and real time pause
- Simple to administration functionality
- A comprehensive maintenance service, ensuring courses are kept up to date
- Randomised exam simulator

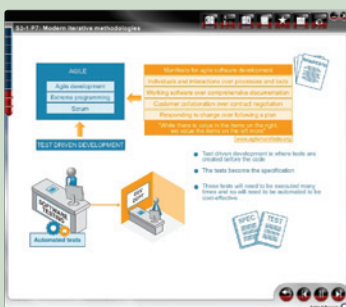

Minimum Requirements
Windows XP or Vista, multimedia based computer with sound.
Flash version 6 or higher.

For further information call ILX on
+44 (0)1270 611600 or visit our website at

www.ilxgroup.com

ISEB Intermediate Certificate in Software Testing E-learning Course

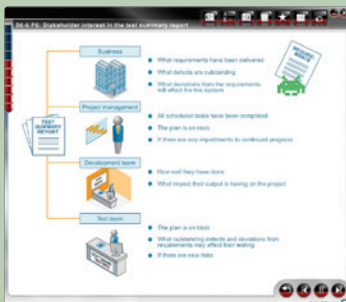

Modules

Module 1 – Introduction

Module 2 – Fundamentals of Testing

- 2.1 Why is testing necessary?
- 2.2 What is testing?
- 2.3 General testing principles
- 2.4 Application domains
- 2.5 Expected results
- 2.6 Exit, Completion, Closure or Acceptance criteria
- 2.7 Fundamental test process
- 2.8 The Psychology of Testing

Module 3 – Testing through the lifecycle

- 3.1 Software development models
- 3.2 Test levels
- 3.3 Functional and Structural Testing
- 3.4 Non-functional System Testing
- 3.5 Re-Testing and Regression Testing
- 3.6 Maintenance Testing
- 3.7 Test environment requirements

Module 4 – Static Techniques

- 4.1 Reviews and the Test Process
- 4.2 Phases of a Formal Review
- 4.3 Static analysis using tools

Module 5 – Test Design Techniques

- 5.1 Identifying test conditions and designing test cases
- 5.2 Categories of test design techniques
- 5.3 Equivalence Partitioning
- 5.4 Boundary Value Analysis
- 5.5 Decision Table Testing
- 5.6 State Transition Testing
- 5.7 Use case Testing
- 5.8 Path Testing
- 5.9 Statement Testing
- 5.10 Branch / Decision Testing
- 5.11 Error-guessing
- 5.12 Exploratory Testing
- 5.13 Test coverage
- 5.14 Choosing Test Techniques

Module 6 – Test Management

- 6.1 Test Organisation
- 6.2 Test management documentation
- 6.3 Test Approaches
- 6.4 Entry and exit criteria
- 6.5 Test Estimation
- 6.6 Test progress monitoring and control
- 6.7 Configuration Management
- 6.8 Risk and Testing
- 6.9 Incident Management

Module 7 – Tool Support for Testing

- 7.1 Types of test tool
- 7.2 Effective use of tools: potential benefits and risks
- 7.3 Introducing a tool into an organisation

Module 8 – Exam Simulator